

# Geelong Gallery

Venue hire  
information

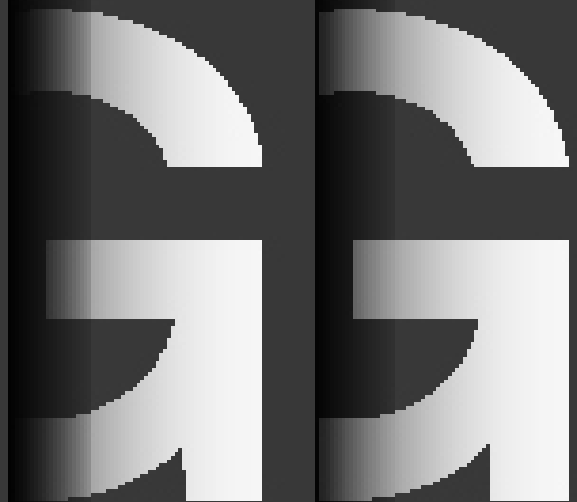

# About Geelong Gallery

---

Geelong Gallery was established in 1896

---

Located in the heart of Geelong's arts precinct, alongside the Geelong Library & Heritage Centre and opposite Geelong Art Centre.

---

Attracts over 120,000 visitors per annum

---

Hosts approximately 12 major exhibitions per annum

---

An after hours function at Geelong Gallery offers exclusive use of the Gallery for your guests

---

Private Director led tours of current exhibitions can also be arranged as part of your event adding an experience to remember

# Gallery spaces & hire

---

**Geelong Gallery provides a variety of spaces suitable for functions accommodating small and intimate events to larger celebrations.**

Geelong Gallery events can accommodate groups from 12 to 300 people. Configuration of spaces range from stand up reception cocktail functions, seated events with catered meals, intimate gatherings for special celebrations, meetings or the presentation of lectures to a seated audience.

---

## **Staffing**

Gallery staff will be on duty during events to ensure the best experience for your guests, and to maintain security of the artworks and the Gallery facility.

## **Catering**

Catering packages are available upon request. Please contact the Gallery's Events and Functions coordinator.

---

## **Equipment requirements**

The Gallery has a selection of furniture suitable for seated seminars and presentations.

Limited audio equipment and cocktail furniture is also available. Ensure you tick the boxes of any equipment required when hiring a Gallery space, our Events and Functions coordinator will let you know if there is anything that needs to be hired at your own cost.

---

## **Opening hours**

The Gallery is open daily 10am–5pm, and is closed on major public holidays including Christmas Eve, Christmas Day, Boxing Day, New Year's Day and Good Friday.

Private hire is subject to availability and is limited during opening hours.

Note: During exhibition changeovers some Gallery spaces will not be available for hire.



Unique spaces to entertain your  
clients or host a special event

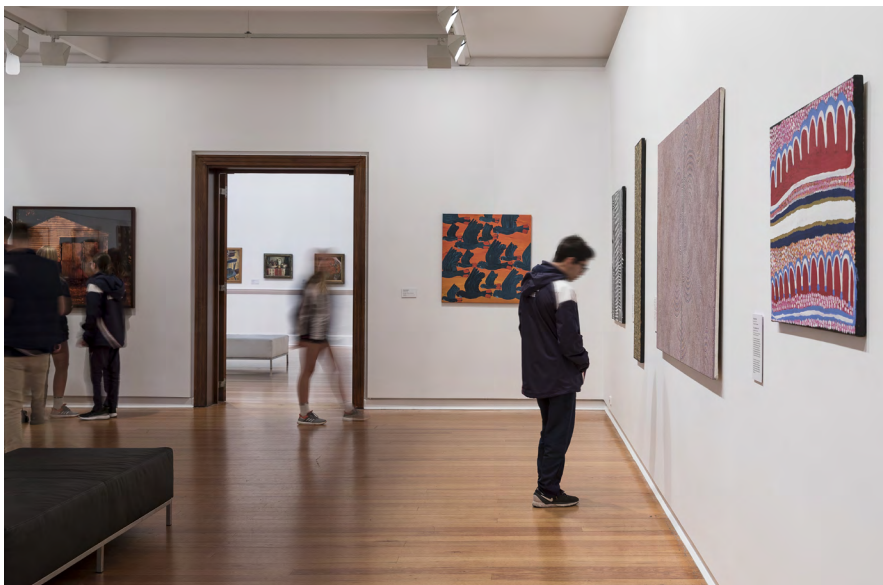

Max Bell Gallery—an intimate venue space showcasing contemporary artists. A drop down screen is also available in this space.



McPhillimy Gallery—bold exhibitions of late 19th and early 20th century works from the collection provide a perfect space for cocktail functions.



Douglass Gallery—a revolving display of significant mid-century works from the Gallery's collection collection, creates the perfect venue for cocktail, presentations or sit-down events.



Hitchcock Gallery—iconic 18th and early 19th century works are displayed in this space, suitable for cocktail events and receptions.

# Navigating the Gallery

- 1 Temporary exhibition space
- 2 Myer Gallery
- 3 McPhillimy Gallery
- 4 Richardson Gallery
- 5 Max Bell Gallery
- 6 Douglass Gallery
- 7 Hitchcock Gallery
- 8 Learn Space
- 9 Decorative Arts

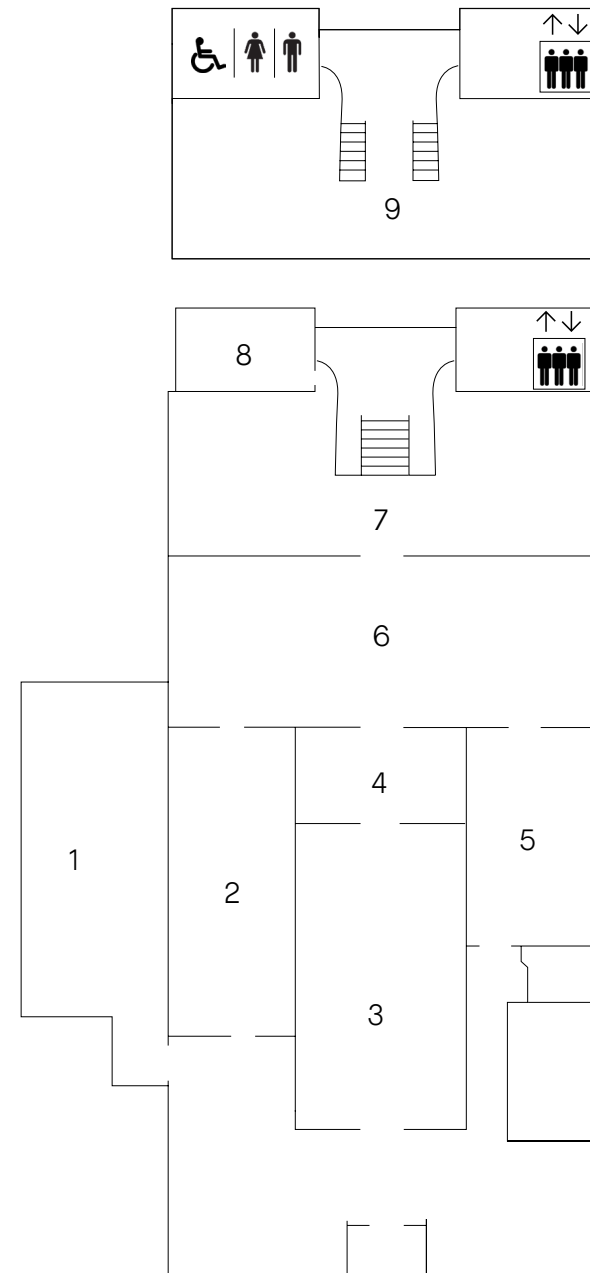

# Facilities and spaces

---

## Temporary exhibition space (178 sqm)

Capacity:  
Reception: 80–150 pax  
Seminar: 50 pax

The Gallery's most recently created, contemporary Gallery space.

---

## Myer Gallery (85 sqm)

Capacity:  
Reception: 50–80 pax  
Seminar: 35–40 pax

Displaying contemporary exhibitions this space provides an ideal venue for a seated seminar or lecture.

---

---

## Max Bell Gallery (105 sqm)

Capacity:  
Reception: 20–80 pax  
Seminar: 60 pax

An ideal venue for a seated seminar or lecture with its ceiling mounted projection screen.

---

## McPhillimy Gallery (135 sqm)

Capacity:  
Reception: 50–150 pax  
Seminar: 70 pax

A gracious space with long sight lines through the Gallery spaces.

---

---

## Douglass Gallery (240 sqm)

Capacity:  
Reception: 250 pax  
Seminar: 110 pax  
Dinner: 60–140 pax

Showcasing the Gallery's permanent collection, this inspiring light-filled space is ideal for larger events.

---

## Hitchcock Gallery (182 sqm)

Capacity:  
Reception: 40–80 pax  
Seminar: 20–40 pax  
Dinner: 40 pax

Enjoy the Gallery's permanent collection in the original Gallery building, constructed in 1915.

---

---

## Douglass Gallery and Hitchcock

Combined capacity:  
Reception: 300 pax

Combining these two inspiring heritage Galleries provides an ideal venue for hosting large functions. There is ample room for a lectern or panel stage.

---

## Learn Space (24 sqm)

Capacity:  
Seminar: 20–25 pax

Ideal space for a private meeting.

---

## Decorative Arts Gallery (26 sqm)

Capacity:  
Seminar: 12 pax

This is a quiet, reflective space and is complemented by exhibitions of works behind illuminated glazed cases.

---



# Thank you

Thank you for taking the time to read this Gallery hire information document. For more information or to arrange a visit, please contact us.

Contact  
Anna Debenham  
Visitor Services Officer—  
Events and Bookings  
[anna@geelonggallery.org.au](mailto:anna@geelonggallery.org.au)  
03 5229 3645

