

# Floorplan— Where to find Orby

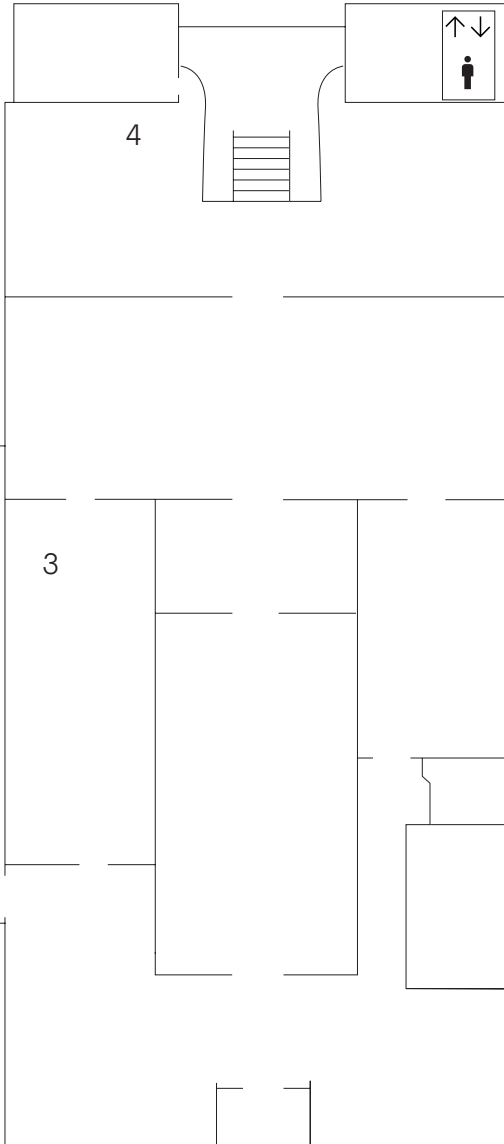
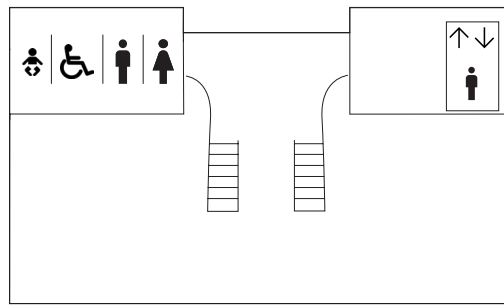

**Geelong Gallery**  
55 Little Malop Street  
Geelong VIC 3220 Australia

T +61 3 5229 3645  
info@geelonggallery.org.au  
geelonggallery.org.au

Open daily  
Monday to Saturday,  
10am–7pm &  
Sunday 10am–5pm

Network: ggex  
Password: exhibitionwifi



# Meet Orby

## Navigating the Gallery

Look out for Orby as you navigate the Gallery

- 1  
Eugene von Guérard  
*View of Geelong* 1856
- 2  
Danila Vassilieff  
*Children playing, Collingwood* c. 1937
- 3  
Christian Thompson  
*Untitled (Banksia leaf)* 2007
- 4  
Robert Dowling  
*Mrs Margaret McArthur of Meningoort* 1856–57  
Requires a ticket to *RONE in Geelong*



## Meet Orby— your digital tour guide

Join Orby on an augmented reality journey to discover key works in the Gallery's collection.

Orby brings works of art to life—sharing artists, stories and fun facts with you and your family in an interactive tour designed to promote curiosity and an appreciation for learning.

Download the free app via the App Store or Google Play.

Apple devices require iOS 13.2 or later.

Orby was created in partnership with Pillowfort Creative and Hanalei Studios and is supported by Helen MacPherson Trust, Creative Victoria and Harvey Norman Waurin Ponds.



# Meet Orby

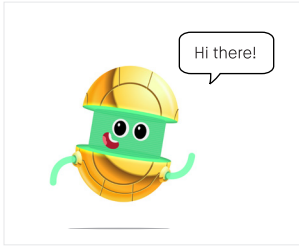

## Orby in the Gallery

Use augmented reality to discover key works in the Gallery's collection with your digital tour guide Orby.

1. Launch 'Orby in the Gallery'
2. Keep an eye out for Orby as you explore our galleries—the works with a picture next to them are Orby's favourites.
3. Scan the artwork using the viewfinder.
4. Tap on the shapes to learn more about Orby's favourite artworks.

Continue on your journey discovering works of art with Orby in the Gallery.



## Orby at Home

Transform your home into a virtual gallery as Orby shares key works from the Gallery's collection with you.

1. Launch 'Orby at home'.
2. Find a clear area. A blank wall is best!
3. Slowly move your device around until yellow dots appear.
4. As more dots appear, a windowpane will appear!
5. Tap to select an artwork to discover with Orby.

There are 11 works for you to discover and you can change the artwork at any time.

1



## Eugene von Guérard

Visit *Scenic Victoria—Land, sea, city* to discover Eugene von Guérard's *View of Geelong* (1856).

Here, Von Guérard documents the beginnings of our city looking northeasterly, from a vantage point near the village of Ceres. Careful attention is paid to the observation of almost every microscopic detail, from the township of Geelong, across to the You Yangs and the even more distant Dandenong Ranges.

Eugene von Guérard  
*View of Geelong* (detail) 1856  
oil on canvas  
Geelong Gallery  
Purchased through the Geelong Art Gallery Foundation with the generous support of the Victorian Government, the Australian Government, the City of Greater Geelong and numerous community and other donors, 2006

2



## Danila Vassilieff

As you explore *Scenic Victoria—Land, sea, city* look out for Danila Vassilieff's painting, *Children playing, Collingwood* (c. 1937).

Vassilieff lived amongst the working class suburbs of Collingwood and Fitzroy which provided ample subject as he worked rapidly to capture everyday streetscenes.

Danila Vassilieff  
*Children playing, Collingwood* (detail) c. 1937  
oil and pencil on canvas  
Geelong Gallery  
Purchased with the assistance of the Caltex-Victoria Government Art Fund, 1979

3



## Christian Thompson

In the next Gallery you will find Christian Thompson's *Untitled (Banksia leaf)* (2007) on display in *Framing the figure—contemporary photography and moving image works from the collection*.

Christian Thompson's photographs extend the history of portraiture to the foreground, exploring Indigenous cultural identity, kinship and connections to Country. By facing the camera, but concealing his eyes with the distinctively serrated leaves of the Banksia tree, Thompson defiantly refuses his audience's return gaze.

Christian Thompson  
*Untitled (Banksia leaf)* (detail) 2007  
c-type print; edition of 10  
Geelong Gallery  
Purchased with funds generously provided by Geelong Contemporary, 2018

4



## Robert Dowling

In the most historical part of the Gallery, you will find some of the oldest paintings on display.

Mrs Margaret McArthur's dignified portrait is one of the finest examples of Victorian portraiture. Mrs McArthur (née McLean) married Victorian pioneer and pastoralist Peter McArthur in Geelong in December 1856. The couple lived at 'Meningoort' station near Camperdown.

Please note, exploring Robert Dowling's painting in the Gallery will require a ticket to *RONE in Geelong*. If you do not have a ticket to this exhibition you can still enjoy this work with 'Orby at home'.

Robert Dowling  
*Mrs Margaret McArthur of Meningoort* (detail) 1856–57  
oil on canvas  
Geelong Gallery  
Purchased with the generous assistance of the Trustees of the Howard Hitchcock Bequest, and with additional support from the Friends of the Geelong Gallery, 2001